

# SL-3 1/4" HEAVY DUTY AIR HYDRAULIC RIVETER

## SPECIFICATIONS :

Blind Rivet Setting Capacity--1/4", 3/16", 5/32", 1/8"  
 Traction Power.....3800Lbs (1700kgs)  
 Stroke ..... 26mm (1")  
 Operating Air Pressure..... 80-100 PSI  
 Length ..... 330mm

Weight..... 5LBS (2.3kgs)  
 Sound Pressure..... 75 dB(A)  
 Vibration ..... < 2.5 M/S<sup>2</sup>  
 Air Consumption..... 3.6 L/ stroke

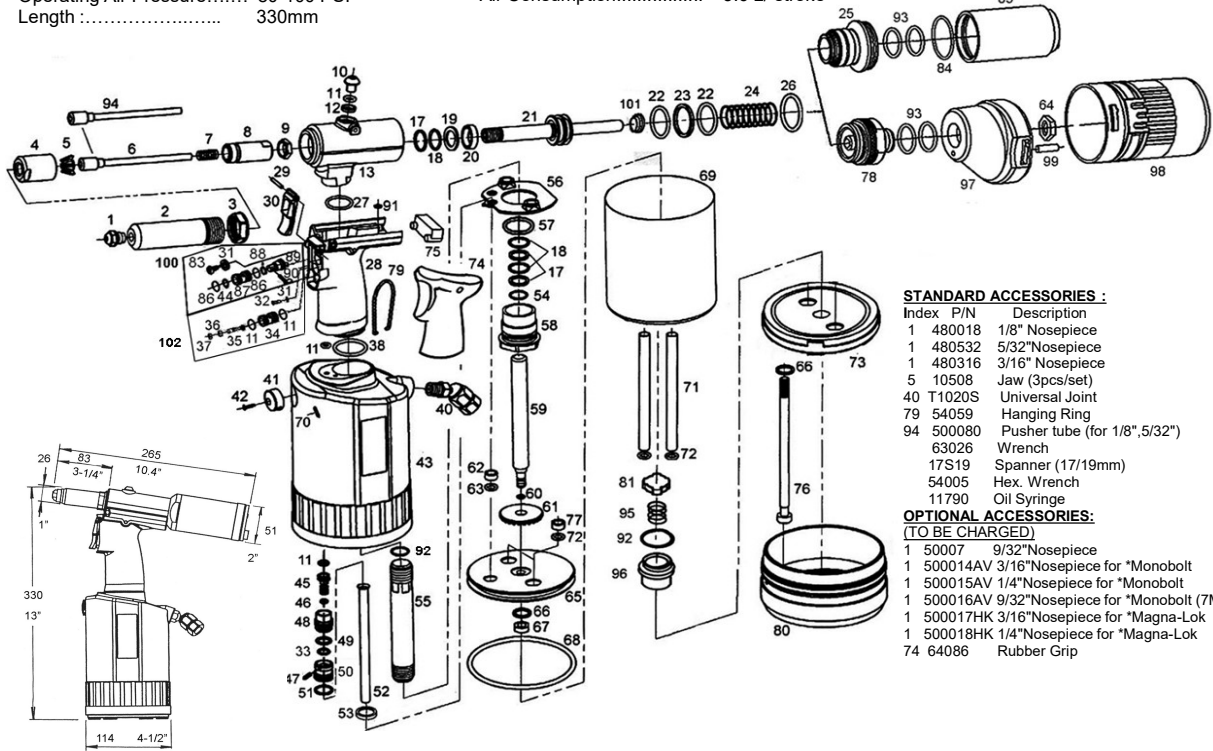

### STANDARD ACCESSORIES :

Index	P/N	Description
1	480018	1/8" Nosepiece
1	480532	5/32" Nosepiece
1	480316	3/16" Nosepiece
5	10508	Jaw (3pcs/set)
40	T1020S	Universal Joint
79	54059	Hanging Ring
94	500080	Pusher tube (for 1/8", 5/32")
	63026	Wrench
	17S19	Spanner (17/19mm)
	54005	Hex. Wrench
	11790	Oil Syringe

### OPTIONAL ACCESSORIES:

(TO BE CHARGED)

1	50007	9/32" Nosepiece
1	500014AV	3/16" Nosepiece for *Monobolt
1	500015AV	1/4" Nosepiece for *Monobolt
1	500016AV	9/32" Nosepiece for *Monobolt (7MM)
1	500017HK	3/16" Nosepiece for *Magna-Lok
1	500018HK	1/4" Nosepiece for *Magna-Lok
74	64086	Rubber Grip

B1501-HF22 4/2012D8

Index No.	Part No.	Description
1	500064	1/4" Nosepiece
2	68015V	Head
3	600016	Nut
4	54009	Jaw Housing
5	500008	Jaws(3pcs/set)
*6	500007A	Pusher Tube
*7	500005	Spring
8	68006	Jaw Housing Couple
9	6801732	Nut
10	02171	Oil Plug
*11	02197	O-Ring Seal (5)
*12	400017A	Fill washer
13	68002V	Hydraulic Section
*17	11554	Washer (3)
*18	11502	X-Ring Seal (3)
*19	6801422	Washer
*20	FU011650	US1 Ø14 x Ø22 x 5
21	68051V	Hydraulic Plunger
*22	11501	O-Ring Seal (2)
*23	11549	Washer
24	5002580	Hyd. Return Spring
25	500070	Screw Plug
*26	55019	O-Ring Seal
*27	R16X17	O-Ring
28	63003V	Hydraulic Handle
29	25018B	Roll Pin
30	63010	Trigger
31	630W3	Washer (2)
32	630M3	Screw
*33	R11X1.2	O-Ring Seal
34	63009	Trigger Bush
35	63016V	Trigger Stem
*36	R2X15	O Ring Seal
*37	R1-9X19	O Ring Seal
*38	630356	O-Ring Seal
*41	63031	Exhaust Cap
42	WS3X10	Screw
43	68005	Air Cylinder Body
*44	31451	O-Ring Seal(5X1)

Index No.	Part No.	Description
45	68038A	Throttle valve
*46	10512	O-Ring Seal
47	SP2X17	Pin
48	68037A	Upper Bush
*49	10445	O-Ring Seal
50	68036A	Law Bush
*51	25022	O-Ring Seal
52	64039	Valve Tube
53	680RW13	Rubber Washer
*54	R18X2	O-Ring Seal
55	63066	Valve pipe
56	68032	Pipe Washer
*57	R266X24	O-Ring Seal
58	68057	Screw Plug
59	68022	Plunger Rod
*60	R5X15	O-Ring Seal
61	63030	Cushion
62	63079	Bush
*63	35039	O-Ring Seal
65	68020	Piston
*66	48047	Washer (3)
67	48048	Nut
*68	R88X53	O-Ring Seal
69	680100	Cylinder Cup
70	400031	Pin
71	68094	Tube (2)
*72	R9-3X23	O-Ring Seal (4)
73	68004V	Cylinder Cap
75	63060	Rubber Plug
76	680150	Bolt (2)
77	68095	Bush (2)
80	680106	Rubber cushion
81	19312	Rubber Plate
83	630BS3X6	Screw
*84	P36X2	O-Ring Seal
85	500610C	Mandrel Bottle Ass'y
*86	R6-4X15	O-Ring Seal (2)
87	63052G	Valve Bush
*88	R4X15	O-Ring Seal (4X1.5)

Index No.	Part No.	Description
89	63053G	Valve Stem
90	63089	Lever
91	64078	Rubber Washer
*92	02170	O-Ring Seal (2)
93	31413	O-Ring Seal (2)
95	19313	Spring
96	68089	Valve Bush
101	54087	Washer Seat
<b>*** OPTIONAL ACCESSORIES ***</b>		
64	620HN18	Nut
78	500070B	Screw Plug
93	31413	O-Ring Seal (2)
97	620090	Cap
98	6200920	Mandrel Bottle Ass'y
99	SP3X8	Pin
<b>100</b>	<b>63052G0</b>	<b>Air Suction Valve Bush Ass'y</b>
<b>Content:</b>		
31	630W3	Washer
44	31451	O-Ring (5x1)
83	630BS3X6	Screw
86	R6-4X15	O-Ring (2)
87	63052G	Valve Bush
88	R4X15	O-Ring (4X1.5)
89	63053G	Valve Stem
90	63089	Lever
<b>102</b>	<b>630090V</b>	<b>Air Valve Bush Ass'y</b>
<b>Content:</b>		
11	02197	O Ring Seal (2)
31	630W3	Washer
32	630M3	Screw
34	63009	Trigger Bush
35	63016V	Trigger Stem
36	R2X15	O Ring Seal
37	R1-9X19	O Ring Seal
<b>If Setting 1/8", 5/32" rivets, you must remove Pusher Tube #6(500007A) &amp; Jaws #5(500008) Then replace with small pusher Tube #94(500080) &amp; Jaws #5(10508)</b>		

" \* " REPAIR KIT