

# BP-60c Spin Pull Spin Hydraulic Rivet Nut Tool (S)

4/2008A

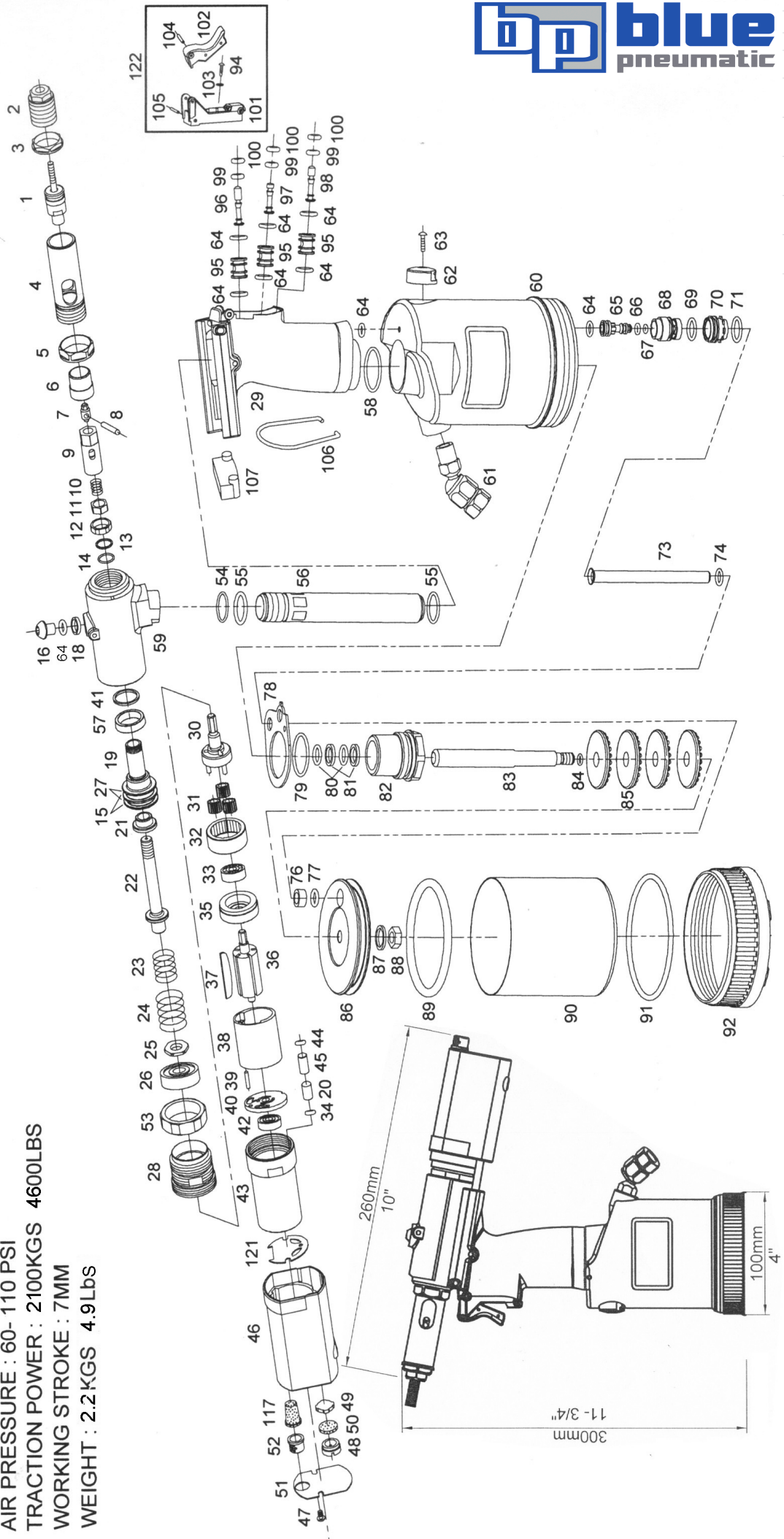

WORK CAPACITY : #8-32, #10-24, #10-32, 1/4"-20  
 5/16"-18, 3/8"-16, 1/2"-13  
 AIR PRESSURE : 60- 110 PSI  
 TRACTION POWER : 2100KGS 4600LBS  
 WORKING STROKE : 7MM  
 WEIGHT : 2.2KGS 4.9lbs

**RD 60c Spin Bull Spin Hydraulic Divot Nut Tool (Standard Thread)**

4/2008A

INDEX NO.	PART NO.	DESCRIPTION
1	6002B38-16	Bolt 3/8"-16
2	62-38	Nut Anvil 3/8"
3	600021	Nut
4	600260	Head
5	600016	Nut
6	600213	Adjustable Bushing
7	600007	Hexagon Bit
8	600041	Spring Pin
9	6000082	Bolt Bushing
10	600076	Spring
11	600009	Nut
12	6000M14	Nut Ring
13	11502	Ring Washer
14	11554	X-Ring Seal
15	11501	O-Ring (2)
16	02171	Oil Plug
18	400017A	Fill Washer
19	600212	Hydraulic Plunger
20	6000631	Valve Rod (2)
21	600020B	Bushing
22	600211	Shaft
23	600015	Spring
24	600045	Spring
25	600054	Washer Nut
26	B6000	Ball Bearing
27	11549	Washer (2)
28	600051	Screw Bushing
29	63003V	Hydraulic Handle
30	600052	Gear Spindle
31	600031	Gear (3)
32	600043	Ring Gear
33	B608	Ball Bearing
34	R06X15	O-Ring (2)
35	600055	Front Plate
36	82507	Rotor
37	82115	Blade (4)
38	85209	Cylinder
39	25006	Pin
40	85230	End Plate
41	6801422	Washer
42	25004	Ball Bearing
43	600061	Motor Housing
44	11560	O-Ring Seal (2)
45	600048	Tube (2)
46	600063	Motor Housing Cover
47	600047	Screw (2)
48	600071	Screw Bushing (2)
49	19312	Rubber plate (3)
50	600050	Valve Muffler (2)
51	600064	Valve Plate
52	600065	Exhaust Cap
53	600058	Nut
54	R16X17	O-Ring
55	R18X2	O-Ring (2)
56	63066	Valve Pipe
57	FU011650	US1 Ø 14 x Ø 22 x 5
58	630356	O-Ring
59	600202	Hydraulic Section
60	63029	Cylinder Body
62	63031	Exhaust Cap
63	25020	Screw
64	2197	O-Ring Seal(9)
65	63038	Throttle Valve
66	10512	O-Ring
67	35016	O-Ring

INDEX NO.	PART NO.	DESCRIPTION
68	63037	Upper Bush
69	10445	O-Ring
70	63036	Lower Bush
71	25022	O-Ring
73	63039	Valve Tube
74	630RW8X2	Rubber Washer
76	63079	Bush
77	35039	O-Ring
78	63032	Pipe Washer
79	R266X24	O-Ring Seal
80	10554	O-Ring Seal (2)
81	10558	O-Ring Washer (2)
82	64057	Screw Plug
83	600322	Plunger Rod
84	R5X15	O-Ring Seal
85	63030	Piston (4)
86	63020	Cushion
87	48047	Washer
88	48048	Nut
89	R70X57	O-Ring Seal
90	63008	Cylinder /Cup
91	R76X35	O-Ring Seal
92	63035	Cylinder Cap
95	63009	Trigger Bush (3)
96	600216	Trigger Stem
97	600217	Trigger Stem
98	600218	Trigger Stem
99	R2X15	O-Ring Seal (3)
100	R1-9X19	O-Ring Seal (3)
107	63060	Rubber Plug
117	600096	Muffler Bush
121	600062	Gasket
<b>122</b>	<b>600900</b>	<b>Trigger Ass'y</b>
<b>Content:</b>		
94		Screw
101		Trigger Seat
102		Trigger
103		Washer
104		Roll Pin
105		Roll Pin
*** Accessories ***		
1	6002B12-13	Bolt 1/2-13
1	6002B516-18	Bolt 5/16"-18
1	6002B14-20	Bolt 1/4"-20
1	6002B10N24	Bolt #10 - 24
1	6002B10N32	Bolt #10 - 32
1	6002B8N32	Bolt #8 - 32
2	62-12	Nut Anvil 1/2"
2	62-516	Nut Anvil 5/16"
2	62-1420	Nut Anvil 1/4"
2	62N10	Nut Anvil #10 (2)
2	62N8	Nut Anvil #8
3	600021	Nut (6)
61	T1020S	Univeral Joint
106	63061	Hanging Ring
*	W24	Wrench 24/27mm
*	54005	Hex. Wrench
*	11790	Oil Syringe
*	WR1719	Wrench
*	600069	Pin
*** Optional Accessories ***		
1	6002B6N32	Bolt #6 - 32
2	62N6	Nut Anvil #6
3	600021	Nut